

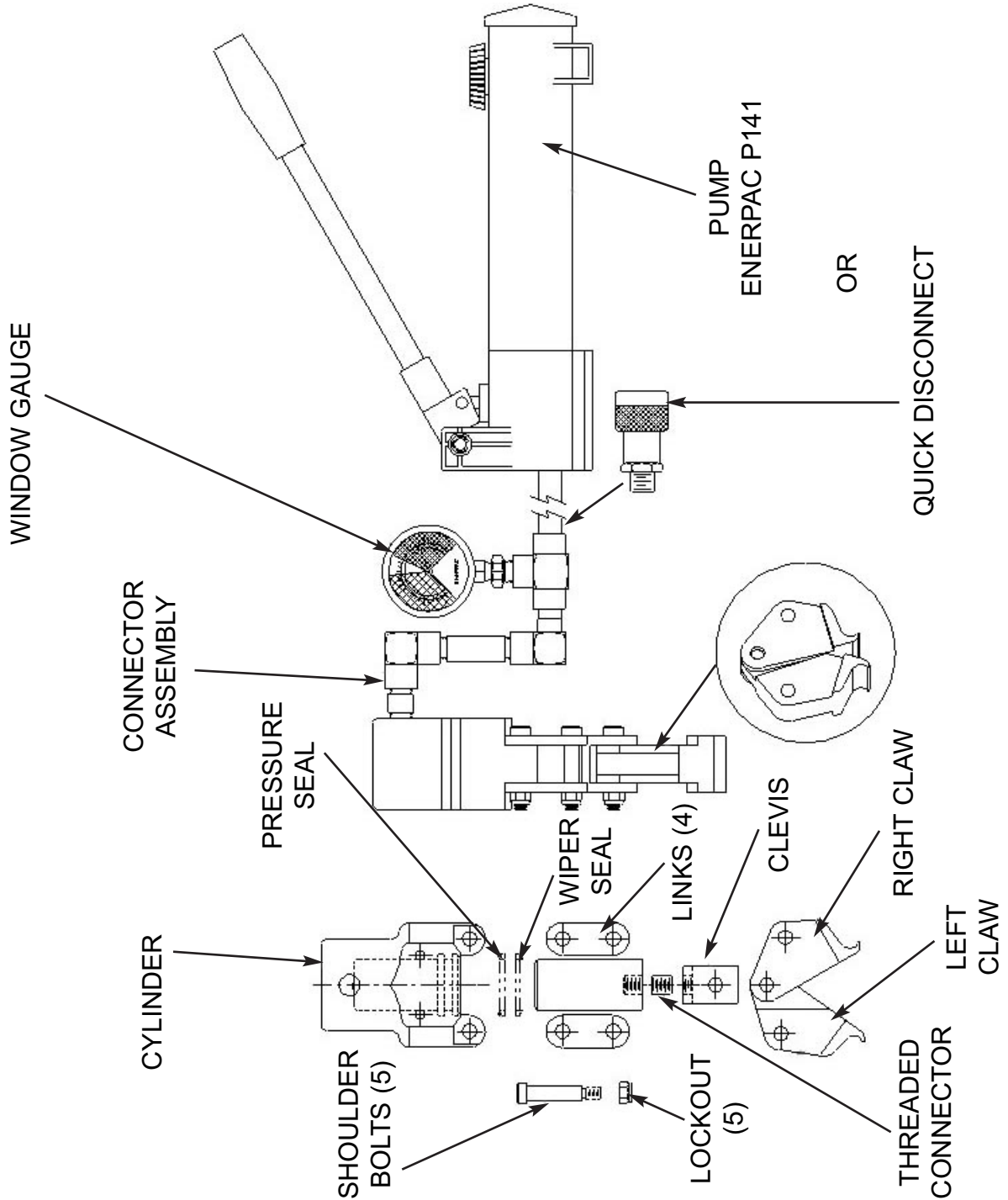

PRESS-BOOT

Providing products and services that protect our planet's clean water supply.

INSTALLATION TOOL



PRESS-SEAL GASKET CORPORATION

P.O. Box 10482, Fort Wayne, Indiana 46852

Phone: (260) 436-0521 (800) 348-7325 Fax: (260) 436-1908 E-mail: sales@press-seal.com Web: www.press-seal.com

MECHANICAL INSTALLATION TOOL

Installation Instructions

1. Loosen tool bolt and collapse arms.
2. Insert tool arms so that short arm is under lower sleeve installation lube and long arm is under upper sleeve installation lube, as shown below. Installation is easier from manhole interior, as shown below.
3. Using the supplied box-end ratchet wrench, tighten bolt until visible compression of rubber boot is achieved. Rubber should gap approximately 1/8" on each side of sleeve when properly compressed.
4. Reverse ratchet and loosen bolt enough to remove from sleeve.
5. Do NOT reuse sleeve removed with this tool. Replace with new sleeve, relubricate, and reinstall boot.

NOTE: Protective Eyewear and clothing should always be used when operating installation equipment.

Tool & Sleeve as seen from Manhole Interior
(preferred installation method)

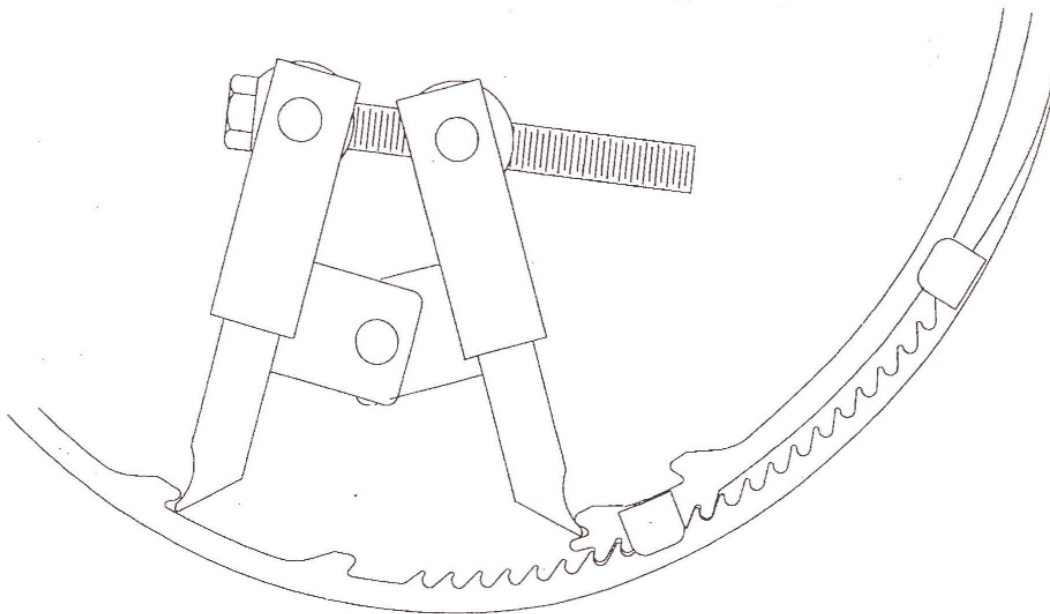

Revised 95DEC14 MRM

Press-Seal believes all information is accurate as of its publication date. Information, specifications, and prices are all subject to change without notice. Press-Seal is not responsible for any inadvertent errors.



PRESS-SEAL GASKET CORPORATION

P.O. Box 10482, Fort Wayne, Indiana 46852

Phone: (260) 436-0521 (800) 348-7325 Fax: (260) 436-1908 E-mail: sales@press-seal.com Web: www.press-seal.com